

ABS - DWV

ABS Drain, Waste & Vent Fittings

ABS - DWV

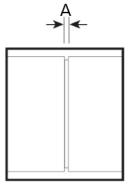

COUPLING		
Part Number	Size	A
ABS100-015	1½	3/32
ABS100-020	2	5/32
ABS100-030	3	3/16
ABS100-040	4	9/32
ABS100-060	6	1/4

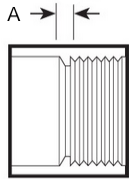

FEMALE ADAPTER		
Part Number	Size	A
ABS101-015	1½	1/4
ABS101-020	2	1/4
ABS101-030	3	5/16
ABS101-040	4	5/16
ABS101-060	6	5/16

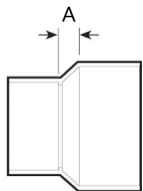

PIPE INCREASER - REDUCER		
Part Number	Size	A
ABS102-251	2 x 1½	17/32
ABS102-337	3 x 1½	1 1/8
ABS102-338	3 x 2	29/32
ABS102-420	4 x 2	1 7/16
ABS102-422	4 x 3	3/4

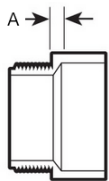

MALE ADAPTER		
Part Number	Size	A
ABS109-015	1½	3/16
ABS109-020	2	7/32
ABS109-030	3	13/32
ABS109-040	4	3/8

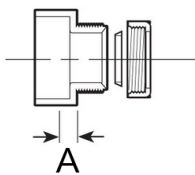

FITTING TRAP ADAPTER		
Part Number	Size	A
ABS113-015	1½	
ABS113-212	1½ x 1¼	1/32

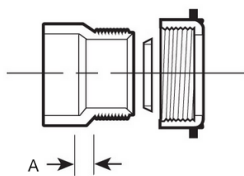

TRAP ADAPTER, FEMALE		
Part Number	Size	A
ABS104-015	1½	7/32
ABS104-212	1½ x 1¼	7/32

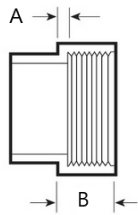

FITTING CLEANOUT ADAPTER

Part Number	Size	A	B
ABS105-015	1½	5/32	13/16
ABS105-020	2	5/32	13/16
ABS105-030	3	7/32	1 1/8
ABS105-040	4	9/32	1 7/32

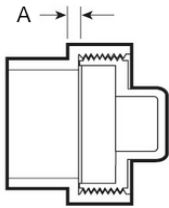

FITTING CLEANOUT ADAPTER + C.O. PLUG

Part Number	Size	A
ABS112-015	1½	5/32
ABS112-020	2	5/32
ABS112-030	3	1/4
ABS112-040	4	9/32

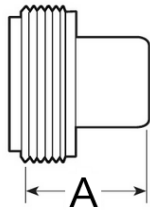

CLEANOUT PLUG, RAISED NUT

Part Number	Size	A
ABS106-015	1½	1 11/32
ABS106-020	2	5/8
ABS106-030	3	1 3/4
ABS106-035	3½	1 3/4
ABS106-040	4	1 7/8
ABS106-060	6	1 31/32

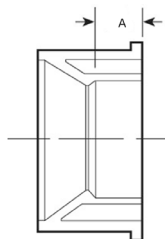

FLUSH BUSHING

Part Number	Size	A
ABS107-251	2 x 1½	27/32
ABS107-337	3 x 1½	3/4
ABS107-338	3 x 2	3/4
ABS107-420	4 x 2	25/32
ABS107-422	4 x 3	1 17/32
ABS107-532	6 x 4	1 25/32



CAP

Part Number	Size	A	B
ABS447-015	1½	1 1/4	11/16
ABS447-020	2	1 9/32	3/4
ABS447-030	3	1 25/32	1 1/2
ABS447-040	4	2	1 3/4
ABS447T-015*	1½	1 1/4	11/16

*THREADED FPT



ADAPTER BUSHING

Part Number	Size	A
ABS117-422	4	1 3/4

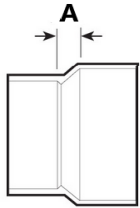

ADAPTER COUPLING

Part Number	Size	A
ABS118-040	4	19/32

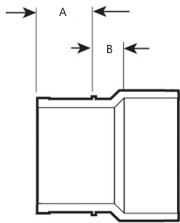

NO - HUB ADAPTER

Part Number	Size	A	B
ABS119-020	2	1 5/32	11/16
ABS119-030	3	1 1/16	13/16
ABS119-040	4	1 1/16	27/32

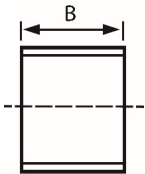

REPAIR COUPLING

Part Number	Size	B
ABS130-015	1½	1 17/32
ABS130-020	2	1 5/8
ABS130-030	3	3 1/4
ABS130-040	4	3 13/16

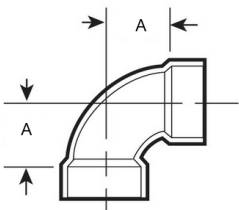

1/4 BEND

Part Number	Size	A
ABS300-015	1½	1 19/32
ABS300-020	2	2 7/32
ABS300-030	3	3 3/32
ABS300-040	4	3 3/4
ABS300-060	6	5 9/32

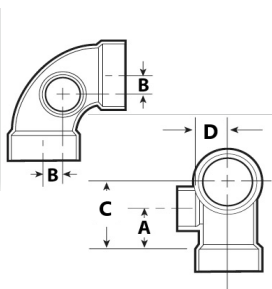

1/4 BEND, w/SIDE INLET

Part Number	Size	A	B	C	D
ABS301-338	3 x 2	2 1/32	1 3/32	3 3/32	1 3/4

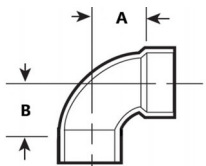

1/4 BEND, STREET

Part Number	Size	A	B
ABS302-015	1½	1 11/16	1 11/16
ABS302-020	2	2 1/4	2 1/4
ABS302-030	3	3 1/16	3 1/16
ABS302-040	4	3 7/8	3 7/8

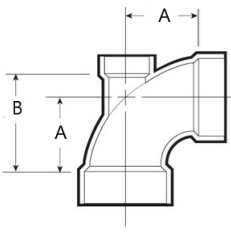

1/4 BEND, w/LOW HEEL INLET

Part Number	Size	A	B
ABS303-337	3 x 1½	2 13/16	4 1/8
ABS303-338	3 x 2	2 13/16	4 13/32

*Assembled from two molded components

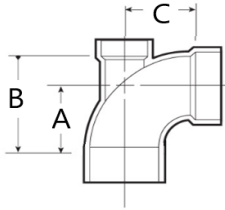

1/4 BEND, w/LOW HEEL INLET HxHxSpigot

Part Number	Size	A	B	C
ABS293-338	3 x 1½	2 31/32	2 7/8	4 7/16

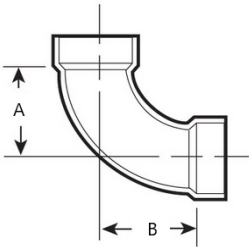

LONG SWEEP 1/4 BEND

Part Number	Size	A
ABS304-015	1½	2 3/4
ABS304-020	2	3 3/16
ABS304-030	3	4 1/16
ABS304-040	4	4 11/16

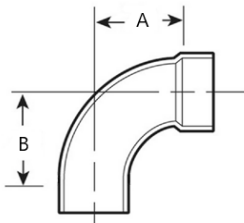

LONG SWEEP 1/4 BEND, STREET

Part Number	Size	A	B
ABS309-015	1½	2 1/2	2 9/16
ABS309-020	2	3 3/32	3 1/32
ABS309-030	3	4 1/32	4 3/32

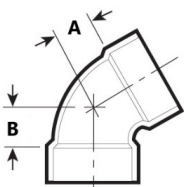

1/6 BEND

Part Number	Size	A	A
ABS319-015	1½	1 1/16	7/8
ABS319-020	2	13/16	13/16
ABS319-030	3	1 5/32	1 5/32
ABS319-040	4	2 1/16	2 1/8
ABS319L-020	2	1 3/8	1 3/8

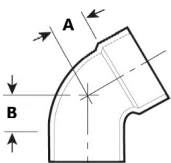

1/6 BEND, STREET

Part Number	Size	A	B
ABS320-015	1½	1	29/32
ABS320-020	2	1 1/4	1 9/32
ABS320-030	3	21/32	31/32

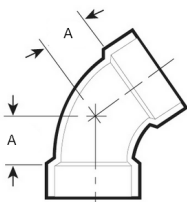

1/8 BEND

Part Number	Size	A
ABS321-015	1½	1 1/16
ABS321-020	2	1 7/16
ABS321-030	3	1 11/16
ABS321-040	4	2 3/16
ABS321-060	6	2

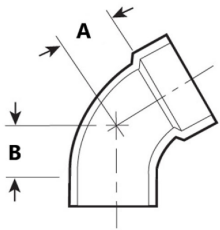

1/8 BEND, STREET

Part Number	Size	A	B
ABS323-015	1½	1 1/16	1 1/16
ABS323-020	2	1 7/16	1 7/16
ABS323-030	3	1 11/16	1 11/16
ABS323-040	4	2 3/16	2 7/32
ABS323-060	6	2	2

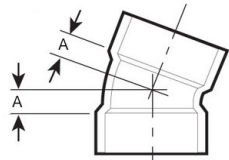

1/16 BEND

Part Number	Size	A
ABS324-015	1½	1/2
ABS324-020	2	11/16
ABS324-030	3	13/16
ABS324-040	4	1
ABS324-060	6	1 15/32

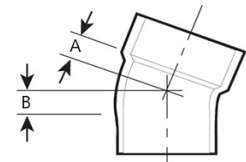

1/16 BEND, STREET

Part Number	Size	A	B
ABS326-015	1½	15/32	15/32
ABS326-020	2	11/16	11/16
ABS326-030	3	21/32	31/32
ABS326-040	4	29/32	1 3/32

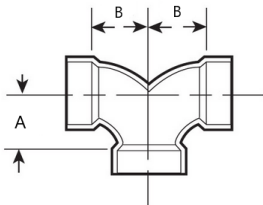

DOUBLE 1/4 BEND

Part Number	Size	A	B
ABS327-015	1½	1 3/4	1 3/4
ABS327-020	2	2 5/16	2 5/16
ABS327-030	3	3 3/32	3 1/16
ABS327-241	2 x 1½	2 5/16	2 5/16

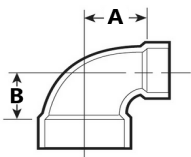

CLOSET BEND, REDUCING, HUBX HUB

Part Number	Size	A	B
ABS329-422	4 x 3	3 9/32	2 7/8

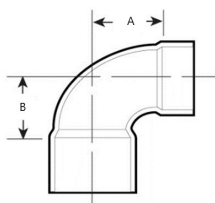

CLOSET BEND, REDUCING, HUBX SPIG

Part Number	Size	A	B
ABS330-422	4 x 3	3 7/32	2 19/32
ABS330X-422	4 x 3	3 3/8	2 3/4

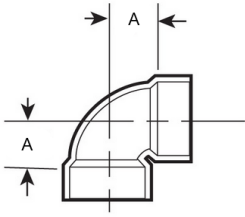

VENT ELL		
Part Number	Size	A
ABS331-015	1½	1 3/16
ABS331-020	2	1 9/16
ABS331-030	3	2

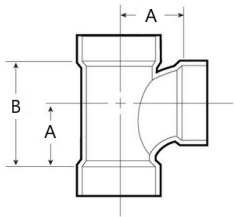

SANITARY TEE			
Part Number	Size	A	B
ABS400-015	1½	1 13/32	2 7/32
ABS400-020	2	1 27/32	3 3/8
ABS400-030	3	2 5/32	4 7/8
ABS400-040	4	3 1/32	5 1/2
ABS400-060	6	4 15/16	8 15/32

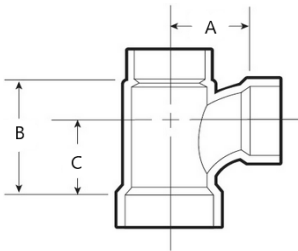

SANITARY TEE, REDUCING				
Part Number	Size	A	B	C
ABS401-241	2 x 1½ x 1½	1 13/16	2 15/16	1 5/8
ABS401-242	2 x 1½ x 2	1 3/4	3 3/8	1 27/32
ABS401-251	2 x 2 x 1½	1 25/32	2 29/32	1 9/16
ABS401-337	3 x 3 x 1½	1 15/16	2 19/32	1 11/16
ABS401-338	3 x 3 x 2	2 7/32	2 21/32	1 1/2
ABS401-420	4 x 4 x 2	3 1/4	3 5/32	2 1/8
ABS401-422	4 x 4 x 3	3 15/32	4 23/32	3 1/32
ABS401-532	6 x 6 x 4	4 5/16	5 25/32	3 11/16

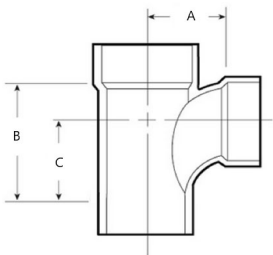

SANITARY TEE, STREET				
Part Number	Size	A	B	C
ABS403-015	1½	1 23/32	2 3/4	1 23/32
ABS403-020	2	2 5/16	3 19/32	2 5/32
ABS403-030	3	3	4 7/8	1 31/32
ABS403-040	4	2 31/32	5 19/32	2 15/16

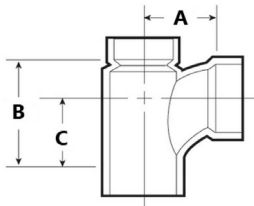

SANITARY TEE, STREET REDUCING				
Part Number	Size	A	B	C
ABS404-241	2 x 1½ x 1½	2 1/8	3 1/8	1 15/16
ABS404-242	2 x 1½ x 2	2 9/32	3 5/8	2 5/16
ABS404-251	2 x 2 x 1½	2 3/16	3 1/8	1 15/16
ABS404-337	3 x 3 x 1½	2 1/2	2 11/16	1 3/4
ABS404-338	3 x 3 x 2	2 27/32	2 7/8	1 19/32

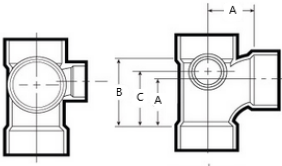

SANITARY TEE w/LEFT SIDE INLET				
Part Number	Size	A	B	C
ABS416-338	3 x 2	3 1/16	4 27/32	3 3/4

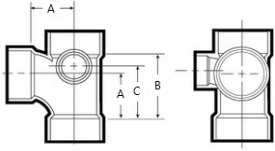

SANITARY TEE w/RIGHT SIDE INLET				
Part Number	Size	A	B	C
ABS417-338	3 x 2	3 1/16	4 7/8	3 3/4

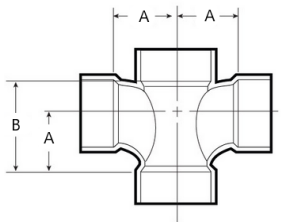

DOUBLE SANITARY TEE				
Part Number	Size	A	B	
ABS428-015	1½	1 27/32	2 3/4	
ABS428-020	2	2 3/8	3 11/16	
ABS428-030	3	3 1/16	4 27/32	
ABS428-040	4	3 29/32	6 1/8	

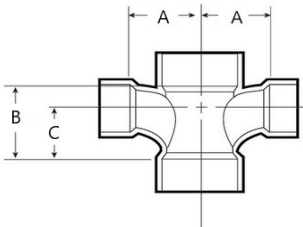

DOUBLE SANITARY TEE, REDUCING				
Part Number	Size	A	B	C
ABS429-252	2 x 1½	2 1/4	3 3/32	1 15/16
ABS429-337	3 x 1½	2 19/32	2 21/32	1 25/32
ABS429-338	3 x 2	2 7/8	3 9/32	2 1/8
ABS429-420	4 x 2	3 9/32	3 3/16	2 1/8
ABS429-422	4 x 3	3 9/16	4 3/4	3 1/32

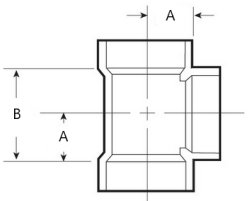

VENT TEE				
Part Number	Size	A	B	
ABS441-015	1½	1 5/32	2 3/8	
ABS441-020	2	1 15/32	2 31/32	
ABS441-030	3	1 27/32	3 13/16	

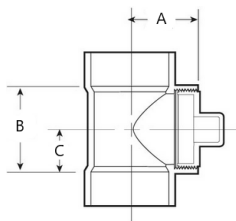

CLEANOUT TEE + C.O. PLUG				
Part Number	Size	A	B	C
ABS443-015	1½	1 13/16	2 3/8	1 3/16
ABS443-020	2	2 1/8	3	1 1/2
ABS443-030	3	2 17/32	3 11/16	1 7/8
ABS443-040	4	3 11/32	4 31/32	2 15/32

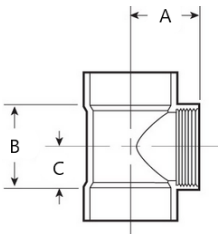

CLEANOUT TEE

Part Number	Size	A	B	C
ABS445-015	1½	1 27/32	2 3/8	1 3/16
ABS445-020	2	2 3/32	3	1 1/2
ABS445-030	3	2 17/32	3 11/16	1 7/8
ABS445-040	4	3 5/16	4 31/32	2 15/32

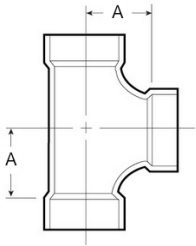

TWO-WAY CLEANOUT

Part Number	Size	A
ABS448-030	3	4 3/32
ABS448-040	4	4 27/32

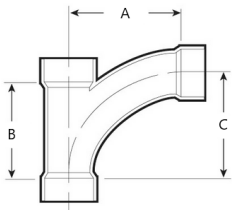

COMBINATION WYE + 1/8 BEND - LONG TURN

Part Number	Size	A	B	C
ABS501-015	1½	3 15/16	3 15/32	3 29/32
ABS501-020	2	5 1/8	4 13/32	5 1/8
ABS501-030	3	7 17/32	6 7/16	7 13/32
ABS501-040	4	9 15/16	8 7/16	9 29/32

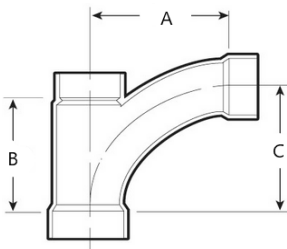

COMBINATION WYE + 1/8 BEND - LONG TURN, REDUCING

Part Number	Size	A	B	C
ABS502-241	2 x 1½	4 7/32	3 1/2	3 29/32
ABS502-251	2 x 1½	4 7/32	3 7/16	3 15/16
ABS502-337	3 x 1½	4 5/8	3 15/32	3 31/32
ABS502-338	3 x 2	5 11/16	4 15/32	5 5/32
ABS502-420	4 x 2	5 1/8	4 7/16	5 1/8
ABS502-422	4 x 3	8 1/16	6 1/2	7 19/32

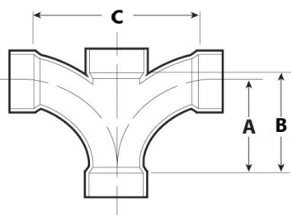

DOUBLE FIXTURE FITTING

Part Number	Size	A	B	C
ABS510-020	2	4 7/32	4 5/8	7 1/8
ABS510-030	3	6 9/32	6 23/32	10
ABS510-241	2 x 1½ x 1½ x 1½	3 1/8	3 7/16	5 9/32
ABS510-251	2 x 2 x 1½ x 1½	1 47/50	4 21/50	4 3/8
ABS510-329	3 x 2 x 3 x 3	6 9/32	6 23/32	10

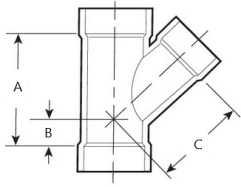

WYE				
Part Number	Size	A	B	C
ABS600-015	1½	4	1 1/8	2 7/8
ABS600-020	2	5	1 5/16	3 5/8
ABS600-030	3	4 9/32	25/32	4 27/32
ABS600-040	4	8 5/16	1 7/8	6 3/8
ABS600-060	6	10 5/32	1 25/32	8 3/8

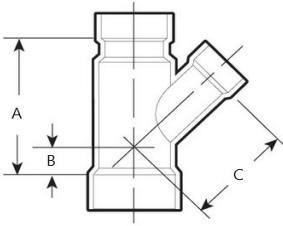

WYE, REDUCING				
Part Number	Size	A	B	C
ABS601-241	2 x 1½ x 1½	4 3/8	1 1/16	3 13/32
ABS601-242	2 x 1½ x 2	4 3/8	1	3 13/32
ABS601-251	2 x 2 x 1½	2 13/16	3/8	2 25/32
ABS601-337	3 x 3 x 1½	4 1/4	5/8	4 3/16
ABS601-338	3 x 3 x 2	4 7/8	29/32	4 3/8
ABS601-419	4 x 4 x 1½	3 1/4	7/32	4 9/32
ABS601-420	4 x 4 x 2	5 1/16	19/32	5 13/32
ABS601-422	4 x 4 x 3	6 5/8	7/8	6 1/8
ABS601-532	6 x 6 x 4	7 1/8	7/16	6 25/32

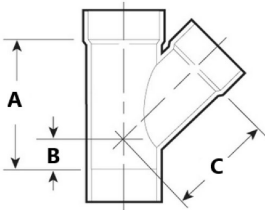

WYE, STREET				
Part Number	Size	A	B	C
ABS602-030	3	6 3/16	1 1/32	5 1/16

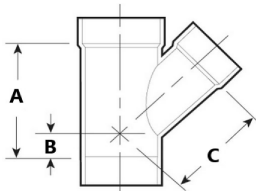

WYE, STREET, REDUCING				
Part Number	Size	A	B	C
ABS603-338	3 x 3 x 2	4 13/16	19/32	4 19/32

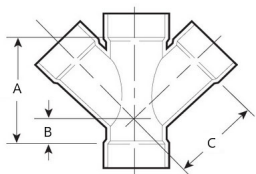

DOUBLE WYE				
Part Number	Size	A	B	C
ABS611-015	1½	3 31/32	1 1/8	2 7/8
ABS611-020	2	5	1 3/8	3 5/8
ABS611-030	3	5 1/8	3/4	4 11/32
ABS611-040	4	8 1/4	1 25/32	6 13/32

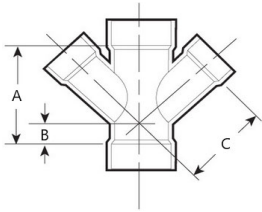

DOUBLE WYE, REDUCING

Part Number	Size	A	B	C
ABS612-252	2x1½	4 5/16	1 1/32	3 13/32
ABS612-338	3 x 2	4 31/32	27/32	4 5/8
ABS612-422	4 x 3	6 19/32	1 1/32	6

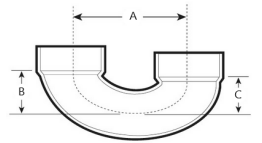

RETURN BEND

Part Number	Size	A	B	C
ABS700-020	2	5 7/32	2 5/32	2 5/32
ABS700-030	3	6 11/16	2 7/8	2 7/8
ABS700-040	4	8 13/32	3 19/32	3 19/32

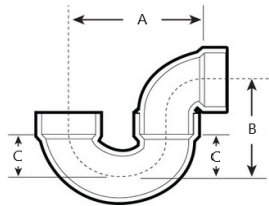

P-TRAP

Part Number	Size	A	B	C
ABS706-015	1½	4 13/16	3 21/32	1 1/2
ABS706-020	2	7 9/32	4 21/32	2 1/8
ABS706-030	3	8 7/8	6 7/16	2 3/4
ABS706-040	4	11 3/8	8 1/2	3 7/16

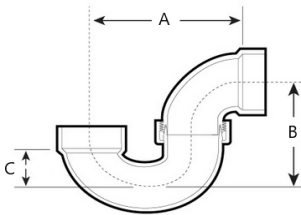

P-TRAP, UNION

Part Number	Size	A	B	C
ABS708-015	1½	5 1/16	3 7/8	1 3/8
ABS708-020	2	6 3/16	5 11/32	2 3/32

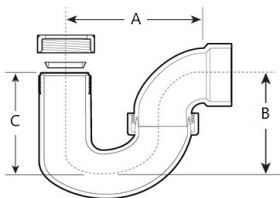

LA PATTERN P-TRAP

Part Number	Size	A	B	C
ABS711-015	1½	5 1/8	4 5/32	3 11/16

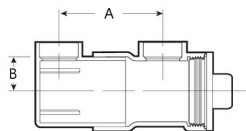

DRUM TRAP

Part Number	Size	A	B
ABS720-015	3 x 6 x 1½	1 3/4	4 7/8

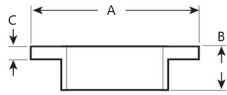

CLOSET FLANGE (One Piece)				
Part Number	Size	A	B	C
ABS800-040	4	2 1/16	2 1/16	15/32

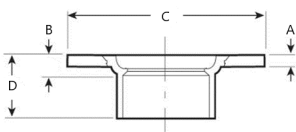

CLOSET FLANGE (One Piece)					
Part Number	Size	A	B	C	D
ABS801-422	4 x 3	7/16	6 31/32	6 31/32	2 5/8

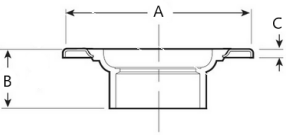

CLOSET FLANGE, ADJUSTABLE w/METAL RING				
Part Number	Size	A	B	C
ABS811-040	4	2 1/16	2 1/16	5/16
ABS811-422	4 x 3	7 1/32	2 5/8	9/32

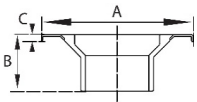

CLOSET FLANGE, ADJUSTABLE w/METAL RING				
Part Number	Size	A	B	C
ABS812-040	4	2 1/4	2 1/4	9/32
ABS812-422	4x3	7 1/32	2 17/32	9/32

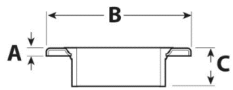

FLUSH CLOSET FLANGE, ADJUSTABLE w/PLASTIC RING				
Part Number	Size	A	B	C
ABS813-040	4	7/16	2 3/32	2 3/32
ABS813-422	4 x 3	7/16	6 31/32	2 5/8

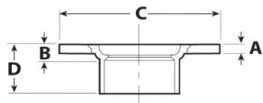

CLOSET FLANGE, ONE PIECE (HUB OR SPIGOT)					
Part Number	Size	A	B	C	D
ABS816-422	4 x 3	0	0	0	0

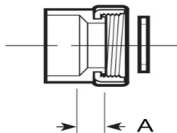

SWIVEL TRAY (STRAINER) ADAPTER w/GASKET		
Part Number	Size	A
ABS900-015	1½ x 1½	15/32

CUSTOMER SERVICE
Phone: (800) 776-2756 | Fax: (731) 772-0835
Email: customerservice@lascofittings.com
www.lascofittings.com

LIMITED WARRANTY

LASCO Fittings, Inc. products are warranted to be free from manufacturing defects in materials and workmanship. They are warranted against rot, rust, and electrolytic corrosion for a period of three years from date of installation. If LASCO products prove defective due to manufacturing defects in material or workmanship during that period, the manufacturer will provide new replacement units of the same type and size. No remedy will be granted under this warranty if LASCO products are not used strictly in accordance with LASCO's directions with respect to use and storage or if the products have been modified in any way.

THE MANUFACTURER'S LIABILITY UNDER EXPRESSED OR IMPLIED WARRANTY OR FOR ANY REASON IS LIMITED TO FURNISHING REPLACEMENT UNITS OR GRANTING A CREDIT FOR DEFECTIVE UNITS. NO LABOR EXPENSE OR CONSEQUENTIAL DAMAGES WILL BE PAID BY LASCO. THIS WARRANTY IS IN LIEU OF ALL OTHER GUARANTEES AND WARRANTIES, EXPRESSED OR IMPLIED, INCLUDING BUT NOT LIMITED TO, WARRANTIES OF MERCHANTABILITY AND FITNESS FOR PURPOSE, EXCEPT FOR ANY WARRANTIES IMPLIED BY LAW FOR NONCOMMERCIAL CONSUMERS. ANY SUCH WARRANTIES ARE LIMITED TO THE DURATION OF THIS WRITTEN WARRANTY.

DO NOT USE LASCO FITTINGS FOR COMPRESSED AIR OR GASES.
DO NOT TEST PVC PIPING SYSTEMS WITH COMPRESSED AIR OR GASES.
DO NOT USE FITTINGS WITH LIQUIDS NOT RECOMMENDED BY LASCO.
MODIFICATIONS OF FITTINGS VOIDS THE WARRANTY.

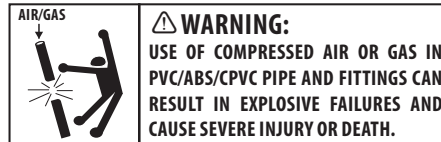

STANDARDS AND SPECIFICATIONS

LASCO ABS DWV Fittings are certified to the Uniform Plumbing Code™, the National Plumbing Code of Canada and NSF/ANSI 14.

- ASTM D-3965 – Acrylonitrile-Butadiene-Styrene (ABS) materials for Pipe and Fittings.
- ASTM D-2661 – Standard specifications for Acrylonitrile-Butadiene-Styrene (ABS) Schedule 40 plastic Drain, waste, and vent pipe and fittings.
- ASTM D-3311 – Drain, Waste, and Vent (DWV) Plastic Fittings Patterns
- MATERIAL – LASCO ABS DWV fittings are produced from virgin black ABS, ASTM D3965 cell classification 32533.

LASCO[®]
Fittings, Inc.

ABS-DC-05